

Qubo

A **Hero**
Group Venture

The QBOOK

SMART AIR PURIFIER Q200



Table of Contents

1. Meet Qubo

2. What's in the box?

3. Let's take a closer look

4. What you need to get started?

5. Using the Smart Air Purifier

6. Using the Qubo App

7. Cleaning the Smart Air Purifier

8. Do's & Don'ts

9. Device Specifications

10. Limited Warranty Statement

11. Instructions

Meet Qubo Smart Air Purifier Q200

Thank you for choosing Qubo Smart Air Purifier!

Have you ever considered the invisible threats lurking in the air you breathe at home? Over time, these pollutants can silently harm your health.

With a rising number of vehicles, industries, and factories, air pollution is a growing concern for us all. Inside your home, a multitude of harmful bacteria, viruses, and the unpleasant odors of toxic gasses, such as formaldehyde, can accumulate.

These pollutants can have a profound impact on your health and the well-being of your loved ones. That's where the Qubo Smart Air Purifier steps in, helping you breathe cleaner, healthier air in your home today. With the cutting edge technology of the Qubo smart air purifier that you have got at home, you can increase your good air days.

What's in the box ?

1. Smart Air purifier Q200
2. Power Cable attached with device
3. Quick Start Guide



Let's take a closer look

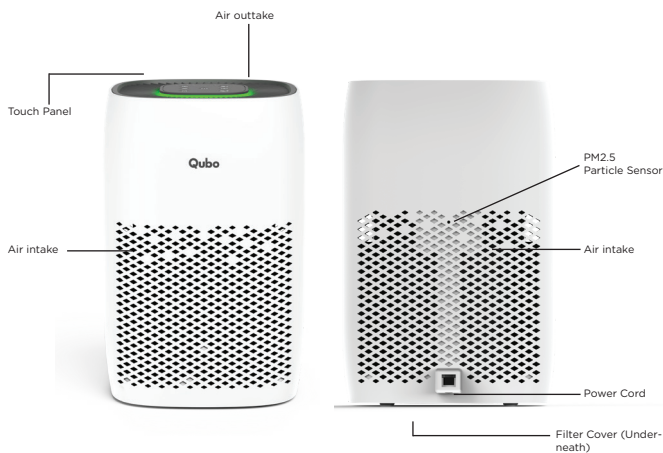

Let's take a closer look



Power
On/Off



QSensAI
Touch to turn on/off the
QAI mode



Timer
Touch for 1/2/4/8h/
no timer



Fan Speed
Touch for Sleep/1/2/3
fan speed



Auto & Child Lock
Short press for Auto mode.
Long press 3 secs for child
lock mode



Filter Reset
Long press 3 secs to enter the
filter reset mode



Light Indicator
Control Low/ Mid/ High

What will you need to get started?

1. Qubo Smart Air Purifier
2. Stable Wi-Fi connection : 2.4 GHz
3. Qubo App



Android
Android 8.9 or higher



iOS
iOS 11 or higher



GET IT ON
Google Play



Download on the
App Store

Note

After downloading the app, please select Wi-Fi connection with 2.4 Ghz bandwidth to start commissioning your smart air purifier.

Let's Get Started

Step-by-step installation

It is recommended that you keep the air purifier at least 1 ft away from the wall for the PM2.5 particle sensor to work accurately.

Step 1

Unlock the air purifier

Put the smart air purifier on the table and turn it over. Hold the rotating cover from the bottom of the product & turn it anticlockwise to unlock and take out the filter.

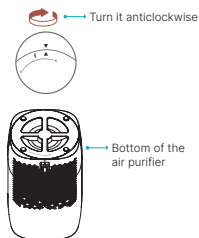

Step 2

Take out the filter & remove polybag

Remove the polybag from the filter and again place the filter in the smart air purifier.

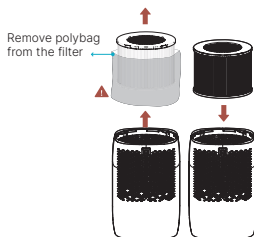

Step 3

Lock & Cover the air purifier

Turn the bottom cover clockwise to tighten it.

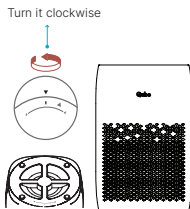

Let's Get Started

Step-by-step installation

Step 4

Open the device and connect the power cable to power source.

Step 5

Download the Qubo app from Google Play or Apple app Store by clicking the below link
<https://www.quboworld.com/apps>

Download the Qubo app:









Step 6

Create an account on the Qubo app and follow the instructions to get started. If you are an existing Qubo user, you can simply go to 'Add Device' on the Qubo app.

Using the Smart Air Purifier

1. Understanding the air quality light

PM2.5	Remarks	Color Code	Possible Health Impacts
0-50	Good		Minimal Impact
51-100	Satisfactory		Minor breathing discomfort to sensitive people
101-200	Moderate		Breathing discomfort to the people with asthma & heart diseases
201-300	Poor		Breathing discomfort to most people on prolonged exposure
301-400	Very Poor		Respiratory illness on prolonged exposure
401-500	Severe		Affects healthy people and seriously impacts those with existing diseases

In a short time the air quality sensors select the color that corresponds to the ambient air quality.

2. Understanding the different modes



QsensAI Mode

Senses the PM2.5 particles in the room and activates the air purifier automatically



Manual Mode

Manually change the fan speed of the air purifier and control air purification in the room.



Auto Mode

Automatically changes the speed of the air purification based on the PM2.5 particles in the room.



Sleep Mode

Noiselessly purifies the air and dims the light indicator to give you a peaceful night's sleep.

Using the Smart Air Purifier

3. Understanding 4 layer filtration system

Your new Qubo Smart Air Purifier uses a 4 layer purification system to deliver pure air in your room by capturing airborne particles as minute as PM2.5 pollutants and other potential disease causing airborne bio-allergens.

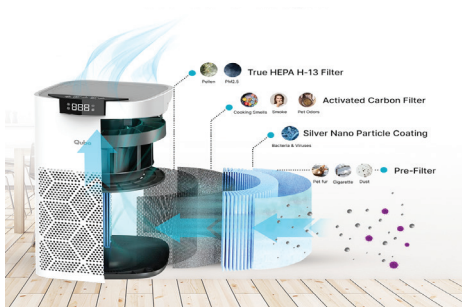

The following are the 4 layers of the filtration of the smart air purifier that work together to deliver the air purifier:

» Pre-Filter

Pre-filter removes the obvious particles that are commonly found in our homes which includes large dust particles, human hair, cloth fibers, pet dander amongst others.

» Nano-silver coating layer

The unique nano-silver coating on the filtration layer has a lasting antibacterial effect which helps remove bio-allergens such as bacteria from the air circulating in the room and contributes to the decrease in probability of the user getting sick.

» Activated Carbon Filter

The granular activated carbon filter helps to remove house-bound odours and helps circulate purified air in the room.

» H13 HEPA Filter

H13 HEPA filter helps to remove the ultrafine particles to the effect of $0.3\text{ }\mu\text{m}$ from the air which includes bio-allergens such as pollen, mold spores, fungi, bacteria & viruses.

Using the Qubo App

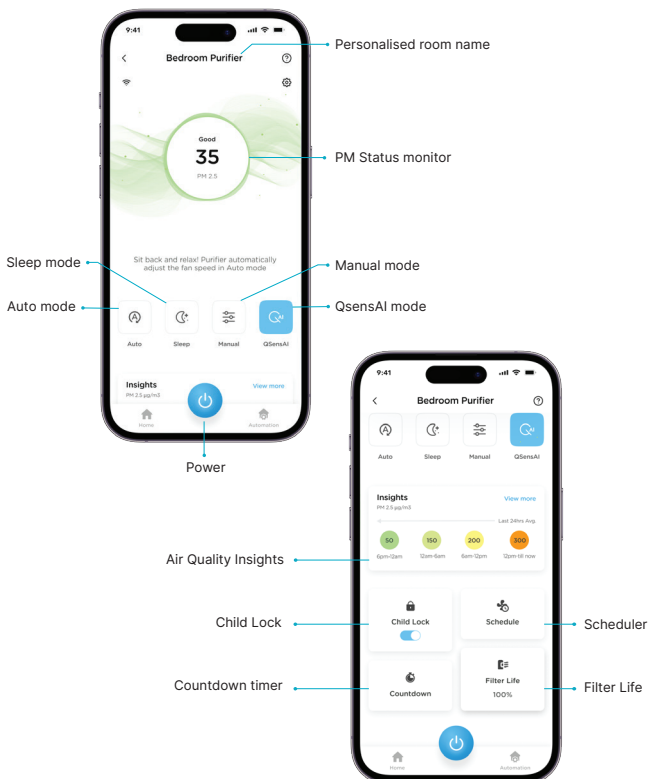

Cleaning the Smart Air Purifier

Cleaning the body of the appliance

Regularly clean the inside and outside of the appliance to prevent dust from collecting.

1. Wipe away dust with a soft dry cloth from the body of the appliance.
2. Clean the air quality sensor side of the body with soft brush for accurate PM2.5 reading
3. Clean the air outlet with a soft dry cloth

Cleaning the Filter

1. Please turn off the power and unplug the device before cleaning the air purifier filters.
2. To remove dust, lightly wipe the filter with a soft, clean cloth.

Replacing the filter

To maintain the performance of the air purifier and purification effect, we advise to replace the filters every 8-12 months or 3000H-9000H, depending on usage of the product.

1. **Unplug the air purifier** from the electrical outlet.
2. **Unlock the air purifier:** Put the smart air purifier on the table and turn it over. Hold the rotating cover from the bottom of the product & turn it anticlockwise to unlock and take out the filter.
3. **Take out the filter:** Place the filter in the smart air purifier.
4. **Lock & Cover the air purifier:** Align with the triangle shape on the bottom cover with the triangle on the machine and turn it clockwise to tighten the cover.

Filter Life Reset

We recommend to reset the filter life once the new filter is replaced. Filter can be reset through Filter life section on App.

However from the device, long press QAI & Timer button together for 3 seconds to reset.

Do's & Don't's

Safety : Read this user manual carefully before you use the appliance, and save it for future reference.

Danger

- Do not let water or any other liquid or flammable detergent enter the appliance to avoid electric shock and/or a fire hazard.
- Do not clean the appliance with water, any other liquid, or a (flammable) detergent to avoid electric shock and/ or a fire hazard.
- Do not spray any flammable materials such as insecticides or fragrance around the appliance.

Warning

- Check if the voltage indicated on the appliance corresponds to the local power voltage before you connect the appliance.
- If the power cord is damaged, please inform & raise concern with Qubo customer care.
- Do not use the appliance if the plug, the power cord, or the appliance itself is damaged.
- This appliance can be used by children aged from 8 years and above and persons with reduced physical, sensory or mental capabilities or lack of experience and knowledge if they have been given supervision or instruction concerning use of the appliance in a safe way and understand the hazards involved. Child shall not play with the appliance. Cleaning and maintenance shall not be made by children without supervision.
- Do not block the air inlet and outlet, e.g. by placing items on the air outlet or in front of the air inlet.
- Make sure that foreign objects do not fall into the appliance through the air outlet

Caution

- This appliance is not a substitute for proper ventilation, regular vacuum cleaning, or use of an extractor hood or fan while cooking. If the power cord is damaged, please inform & raise concern with Qubo customer care.
- If the power socket used to power the appliance has poor connections, the plug of the appliance becomes hot. Make sure that you plug the appliance into a properly connected power socket.
- Always place and use the appliance on a dry, stable, level, and horizontal surface.
- Leave at least 20cm free space behind and on both sides of the appliance and leave at least 30cm free space above the appliance.

Do's & Don't's

- Do not place anything on top of the appliance.
- Do not sit or stand on the appliance. Sitting or standing on the appliance may lead to potential injury.
- Do not place the appliance directly below an air conditioner to prevent condensation from dripping onto the appliance.
- Make sure all filters are properly installed before you switch on the appliance.
- Only use the original filters specially intended for this appliance. Do not use any other filters.
- Combustion of the filter may cause irreversible human hazard and/or jeopardize other lives. Do not use the filter as fuel or for similar purposes.
- Avoid knocking against the appliance (the air inlet and outlet in particular) with hard objects.
- Do not insert your fingers or objects into the air outlet or the air inlet to prevent physical injury or malfunctioning of the appliance.
- Do not use this appliance when you have used indoor smoke-type insect repellents or in places with oily residues, burning incense, or chemical fumes.
- Do not use the appliance near gas appliances, heating devices or fireplaces.
- Always unplug the appliance after use and before cleaning, or carrying out other maintenance or replacing the filters.
- Do not use the appliance in a room with major temperature changes, as this may cause condensation inside the appliance.
- To prevent interference, place the appliance at least 2 meters away from electrical appliances that use airborne radio waves such as TVs, radios, and radio-controlled clocks.
- The appliance is only intended for household use under normal operating conditions.
- Do not use the appliance in wet surroundings or in surroundings with high ambient temperatures, such as the bathroom, toilet, or kitchen.
- The appliance does not remove carbon monoxide (CO) or radon (Rn). It cannot be used as a safety device in case of accidents with combustion processes and hazardous chemicals.
- If you need to move the appliance, disconnect the appliance from the power supply first.
- Do not move the appliance by pulling its power cord.
- Always cleanse your hands after changing the filters.

Device Specifications

Performance	Coverage Area	200 Sq ft
	CADR	150 m3/h
Function	Voltage	AC 220 – 240 V
	Power	38W
	Max Noise	51 dB/A
	PM 2.5 Sensor	Yes
	Wi-Fi	Yes
	Motor	AC
Filter	No of Filters	4 in 1 (Pre Filter , Nano Silver Anti-Bacteria filter , Activated Carbon Filter, H13 Hepa Filter)
	Filter Life - Subject to usage , depending on Fan Speed	9000 Hrs*
Size	Dimension	205 * 205 * 313 mm
	Weight	2.4 Kg

Limited Warranty Statement

Thank you for selecting the Qubo Smart Air Purifier by Hero Electronix.

NOTE : This is a simplified and concatenated version of the standard warranty terms and conditions. You can reach out to our toll free helpline number to know about the same.

Important:

Please retain your receipt as proof of purchase. HERO Electronix Private Limited warrants to the owner of the Smart Air Purifier, (henceforth referred as Device) that the Device will be free of defects in material and workmanship for a period as mentioned below.

Item	Warranty Period	Scope of Warranty
Device	12 months from the date of Purchase	This warranty covers only the defects in products arising from manufacturing or faulty workmanship.
Filter	No warranty	

During this warranty period, if any defect arises in the Device, HERO Electronix will either (i) repair the device free of cost with either new or refurbished parts, or (ii) replace the part that is faulty with a new or refurbished part. This limited warranty applies to any repair or replacement part for the remainder of the original warranty period or for 90 (Ninety) days, whichever period is longer.

This limited warranty is non-transferable.
This limited warranty is only valid in India

Instructions:

For specific instructions about how to obtain warranty services for your Device, please contact our toll-free helpline

Instructions

THIS LIMITED WARRANTY DOES NOT COVER THE FOLLOWING (COLLECTIVELY INELIGIBLE PRODUCTS)

- (i) If the warranty seal on the Device is broken.
- (ii) Devices that have been subjected to: (a) modifications, alterations, tampering or improper maintenance and repair (b) handling, storage, installation, testing or use not in accordance with any User guide, Placement guidelines, other instructions provided by HERO Electronix (c) abuse or misuse of the product. (d) breakdown, fluctuations, or interruptions in electrical power or the telecommunication network; or (e) Acts of God, including but not limited to lighting, flood, tornado, earthquake or hurricane.
- (iii) errors and damages caused by: (a) liquid ingress, or spilled food, or physical abuse, or normal wear and tear, (b) use of or being connected to any accessory which was not supplied or authorised by HERO Electronix.
- (iv) Plastic components like front or back covers plus rubber components.
- (v) Physical or cosmetic damage to Silicon cover



CORRECT DISPOSAL OF THE PRODUCT

In case you need to dispose of this device at any time in the future, please contact our toll-free helpline. To facilitate effective utilisation of resources, we will arrange the disposal of this device as per the prevailing laws. Please note that electrical products should not be disposed of with household waste.

FOR ALL PRODUCT RELATED COMPLAINTS/ASSISTANCE, PLEASE CONTACT

Hero Electronix Pvt. Ltd. 503, 5th Floor Rectangle 1,

D4, Saket District Center, New Delhi - 110017

Email us at: helpdesk@quboworld.com | 1800-572-5757

www.quboworld.com