

Quick Start Guide

Smart Air Purifier

R700



CONTENTS

01

Product Overview

- i. Know your Smart Air Purifier
 - ii. Control Panel
-

02

Filter Setup & Maintenance

- i. Installing the Filter
 - ii. Cleaning the Filter
 - iii. Replacing the Filter
-

03

Optimal Placement for Your Smart Air Purifier

04

Qubo App

- i. Connect Your Air Purifier to Qubo App
- ii. App Features & Controls
- iii. Remote Control

Product Overview

Know your Smart Air Purifier

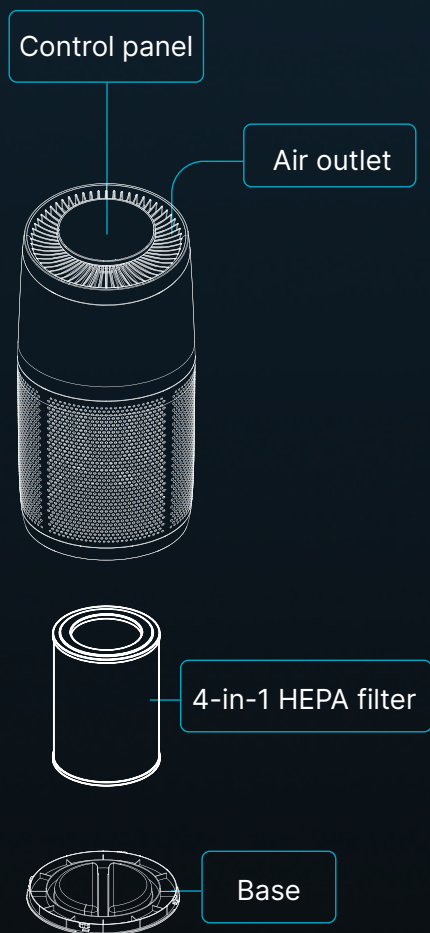

Images in the Quick Start Guide are just representative of the devices and are for the purpose of guiding through the initial set-up process only.

Control Panel

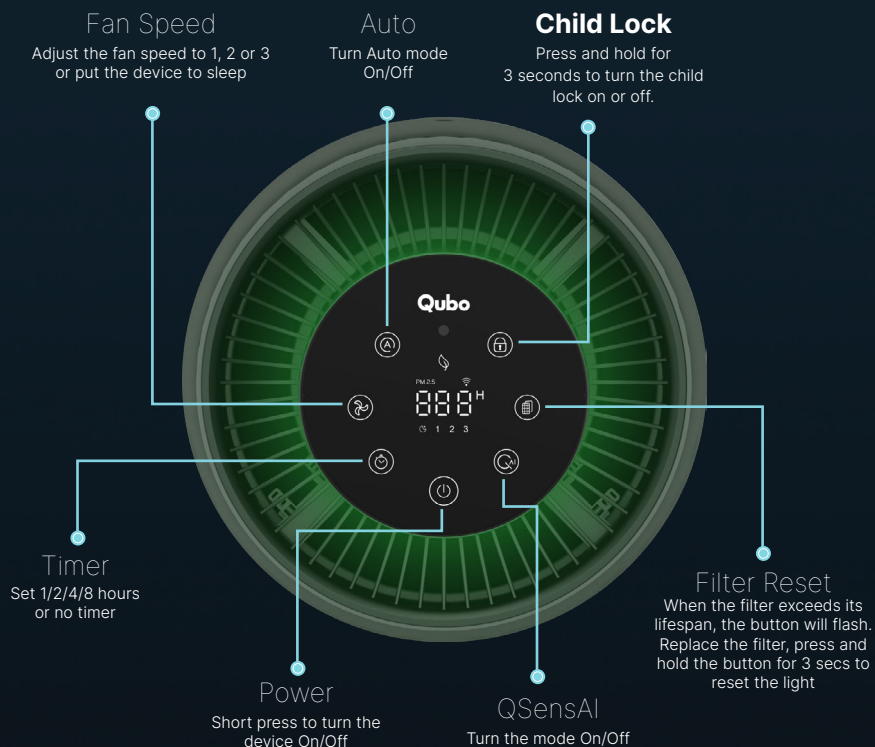

Display Panel

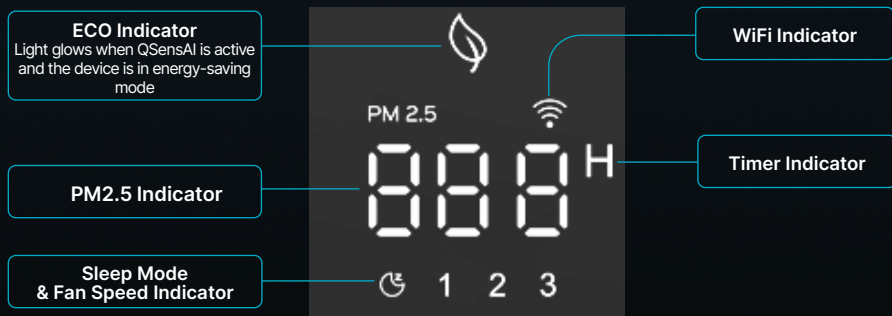

Filter Setup & Maintenance

Installing the Filter

Note: Always disconnect the air purifier from the power source before installing the filter.

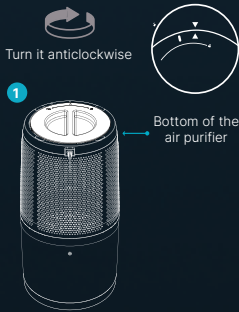

Rotate the base
anti-clockwise
to remove it



Take out the filter
from the air purifier



Remove the polybag
from the filter



Place the filter back
in the air purifier

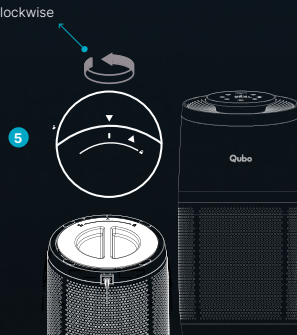

Reattach the base
and rotate in clockwise

Images in the Quick Start Guide are just representative of the devices and are for the purpose of guiding through the initial set-up process only.

Cleaning the Filter

Step 1

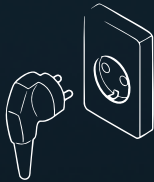

Turn off and unplug the air purifier

Step 2

Turn it anticlockwise

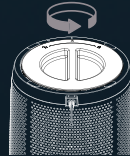

Twist & remove the base and take out the filter

Step 3

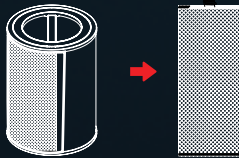

Detach the Velcro to separate the pre-filter from the main filter

Step 4

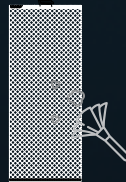

Clean the pre-filter with a dry brush and place it back

Step 5



Place the filter back in the air purifier

Step 6



Reattach the base and rotate in clockwise

Cleaning Frequency

- **Pre-Filter:** Once every month*

**When the air is more polluted, clean the pre-filter with dry cloth once a month for best performance.*

- **Replacing the Filter**

Replace the main filter once a year*.

**Subject to actual usage.*

Optimal Placement for Your Smart Air Purifier



Seal the room: Keep windows and doors shut while the purifier is running. This helps it clean the air faster and maintain freshness for longer.

Maintain distance: Place the purifier at least 1 foot away from walls or large furniture so it can pull in and circulate air effectively.



1 ft.

Qubo App

Connect Your Air Purifier to Qubo App



1. Scan the QR code to download the Qubo App.
2. Sign up to create your account with Qubo.

3. Switch on your Smart Air Purifier.
4. Tap on the Menu.
5. Tap on 'Add Devices'.
6. After choosing the device's location tap on 'Purifier' and select Smart Air Purifier R700.

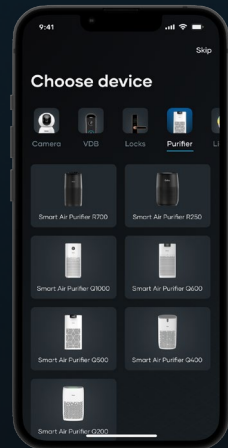

7. Tap on 'Continue' if you see the white light blinking on the device. If you do not spot the light blinking, long press the 'Power button' for 10 seconds and reset the device.

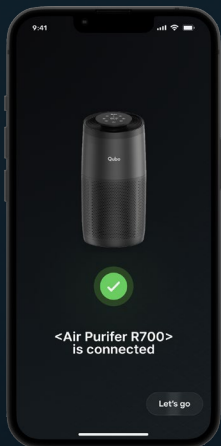
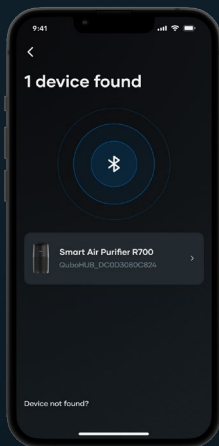

8. The app will search for the air purifier via Bluetooth. Make sure your Bluetooth is turned on to discover the device.

9. After scanning, select 'R700' in the 'Add Device' section.

10. Name your air purifier and attach a location to it.

11. Enter your Wi-Fi ID and password. Make sure you are on a 2.4Ghz Wi-Fi network.

12. After setup is complete, tap on 'Continue'.

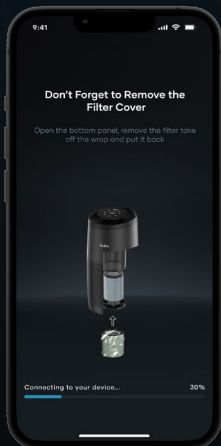
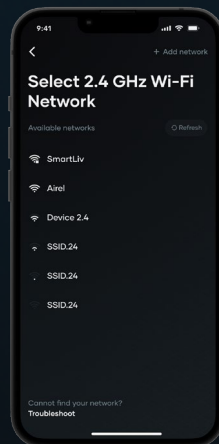

13. On successful authentication of Wi-Fi, your device will be connected to the app.

App Features & Controls



App Features & Controls

Feature	Description
Power Button	Switch on/off remotely via app
Auto mode	Automatically changes the fan speed based on the PM2.5 pollutants in the room
Sleep Mode	Super silent air purification with display turned off for undisturbed sleep
Manual Mode	Manually change the fan speed of the air purifier to control purification in the room
QSensAI	Senses PM2.5 pollutants and automatically switches on & off the air purifier based on ambient air quality, ensuring efficient purification
Insights	Track indoor and outdoor PM2.5 levels and daily runtime. Use this data to schedule your air purifier usage for optimal performance and better indoor air quality control
Child Lock	With the Child Lock feature turned on via the Qubo App, you can disable all the physical buttons of your air purifier
Schedule	You can schedule your air purifier to fit your daily routine. Choose the days of the week, the time, and even the purifier's functions (like power, mode and fan speed) to suit your needs
Countdown	Set a timer for the air purifier to automatically turn off after 1, 2, 4, or 8 hours

Control Remotely



1. Switch on your Smart Air Purifier
2. Open the Qubo App
3. Log in using the same account credentials that you used to add the Air Purifier
4. Select the Air Purifier you want to control



**Scan the QR code for
any product related issues**